



R I D E

B E Y O N D

DEALER PROGRAM 2020



#RIDEBEYOND

ENGINEERED IN GERMANY
SINCE 1993

SMART
PERFORMANCE
BIKES

JAM²



TOP FEATURES



AIRFLOW



F.O.L.D.
FOCUS OPTIMIZED LINKAGE DESIGN



FLIP CHIP



S.S.P.S.
STABLE STIFFNESS PER SIZE



T.E.C.
TAILORED ENERGY CONCEPT

E-MTB FULLY / ALL-MOUNTAIN

MORE MOUNTAINS, MORE TRAILS, MORE EXPERIENCES

CONQUERS NEW MOUNTAINS

· 150 MM F.O.L.D. FULL SUSPENSION

· 27+ (PLUS), 29" (NINE) OR 29"/27+ (DRIFTER) WHEELS / TYRES

· SHIMANO E8000 DRIVE WITH 756 WH, OR
BOSCH PERFORMANCE CX DRIVE WITH 625 WH

LIGHTWEIGHT AND SEXY

Thanks to its low weight, the JAM² can climb every mountain – and it will do it in style. The e-drive is perfectly integrated into the down tube and very little energy is wasted thanks to the low weight of the bike.

OPTIMAL SUSPENSION PERFORMANCE IN ANY SITUATION

Our F.O.L.D. chassis has been specially designed to meet the increased demands placed on e-MTBs. This means that we can also guarantee the perfect mix for the e-All-Mountain JAM²: F.O.L.D. is extremely sensitive while being progressive enough to prevent a harsh bottom out.

HANDLING CHARACTERISTICS MATTER

We use only those drives and batteries that enable us to create a modern, agile and aggressive geometry for the JAM² thanks to their compact construction. This means that you will have just as much fun out on the trail as with our non-electric JAM.



JAM² ALL-MOUNTAIN



Sandbrown

JAM² 6.9 DRIFTER

WHEELSIZE	29 / 27	29 / 27	29 / 27	29 / 27
SIZE / CM	S / 41	M / 44	L / 47	XL / 50
ARTICLE NO. EU / BEI	637514060	637514061	637514062	637514063



Magic Black

JAM² 6.8 NINE

WHEELSIZE	29	29	29	29
SIZE / CM	S / 40	M / 42	L / 45	XL / 49
ARTICLE NO. EU / BLK	637518105	637518106	637518107	637518108
ARTICLE NO. EU / BLU	637518115	637518116	637518117	637518118



7005 hydroformed aluminium, 3D forging, 150 mm F.O.L.D. kinematic, 148x12 mm thru axle, internal cable routing, post mount 180 mm



Marzocchi Bomber Z1, 3-position lever, 15x110 mm QR



Fox Float DPS Performance, 3-position lever, 210/55 mm, hardware: 25,0 x 8 mm, custom tune



150 mm / 150 mm



Shimano Steps E8000, 70 Nm, 250 W



FOCUS T.E.C. 756 Wh (378 Wh internal plus 378 Wh external)



Shimano Steps E7000, black / white LCD display, walk assist, bluetooth



Shimano Deore XT M8100, 12-speed



Shimano Deore XT M8100, 12-speed



Shimano SLX M7100, 12-speed



Shimano FC-E8000



Front: 34, rear: 10-51



RaceFace Chester 35, aluminium, 780 mm, rise: 35 mm, backsweep: 8degree



Race Face Gripper



Race Face Affect R 35, 50 mm



Acros AZX-212 AH, 1-1 / 8", tapered, 44 / 286-ZS56 / 40



Proxim W350



Kindshock E30i, 31,6 mm



Shimano XT M8120, 4 piston



200 / 200



Mavic E-XA Drifter (29" front / 27,5" + rear), 622-30 / 584-35, 110x15 mm / 148x12 mm



Maxxis Minion DHF 2.6 3C Exo TR



Maxxis Minion DHR+ 2.8 Dual Exo TR



Sandbrown



21,7 kg



7005 hydroformed aluminium, 3D forging, 150 mm F.O.L.D. kinematic, 148x12 mm thru axle, internal cable routing, post mount 200 mm



Fox 34 Rhythm, sweep adjust, 15x110 mm QR



Fox Float DPS Performance, 3-position lever, 210/55 mm, hardware: 25,0 x 8 mm, custom tune



150 mm / 150 mm



Bosch Performance CX Gen4, 75 Nm, 250 W



Bosch Powertube, 625 Wh, removeable, lockable



Bosch Kiox



Shimano SLX M7100, 12-speed



Shimano Deore XT M8100, 12-speed



Shimano SLX M7100, 12-speed



FSA CK-320, aluminium



Front: 34, rear: 10-51



BBB Ascension BHB-110, aluminium, riserbar, 780 mm, rise: 20 mm, backsweep: 9degree



BBB Cobra BHG-96



BBB Jumper BHS-138



VP Components, ZS56 / 28,6-ZS56 / 40



Proxim W350



Kindshock E30i, 31,6 mm



Shimano BR-MT520, 4 piston



200 / 200



RaceFace AR30 Offset



Novatec D041, 15x110 mm / Novatec D162 Disc, 12x148 mm



Maxxis Rekon 2.6 Dual Exo TR



Magic Black, Stone Blue



23,5 kg



Magic Black

JAM² 6.8 PLUS

WHEELSIZE	27	27	27	27
SIZE / CM	S / 40	M / 42	L / 45	XL / 49
ARTICLE NO. EU / BLK	637518125	637518126	637518127	637518128
ARTICLE NO. EU / BLU	637518135	637518136	637518137	637518138



Magic Black

JAM² 6.7 NINE

WHEELSIZE	29	29	29	29
SIZE / CM	S / 40	M / 42	L / 45	XL / 49
ARTICLE NO. EU / BLK	637518140	637518141	637518142	637518143
ARTICLE NO. EU / BLU	637518150	637518151	637518152	637518153



7005 hydroformed aluminium, 3D forging, 150 mm F.O.L.D. kinematic, 148x12 mm thru axle, internal cable routing, post mount 200 mm



Fox 34 Rhythm, sweep adjust, 15x110 mm QR



Fox Float DPS Performance, 3-position lever, 210/55 mm, hardware: 25,0 x 8 mm, custom tune



150 mm / 150 mm



Bosch Performance CX Gen4, 75 Nm, 250 W



Bosch Powertube, 625 Wh, removeable, lockable



Bosch Kiox



Shimano SLX M7100, 12-speed



Shimano Deore XT M8100, 12-speed



Shimano SLX M7100, 12-speed



FSA CK-320, aluminium



Front: 34, rear: 10-51



BBB Ascension BHB-110, aluminium, riserbar, 780 mm, rise: 20 mm, backsweep: 9degree



BBB Cobra BHG-96



BBB Jumper BHS-138



VP Components, ZS56 / 28,6-ZS56 / 40



Proxim W350



Kindshock E30i, 31,6 mm



Shimano BR-MT520, 4 piston



200 / 200



RaceFace AR40 Offset



Novatec D041, 15x110 mm / Novatec D162 Disc, 12x148 mm



Maxxis Rekon+ 2.8 Dual EXO TR



Magic Black, Stone Blue



23,7 kg



7005 hydroformed aluminium, 3D forging, 150 mm F.O.L.D. kinematic, 148x12 mm thru axle, internal cable routing, post mount 200 mm



Rock Shox Recon RL, 110x15 mm QR



RockShox Deluxe Select, 210/55 mm, hardware: 25,0 x 8 mm, custom tune



150 mm / 150 mm



Bosch Performance CX Gen4, 75 Nm, 250 W



Bosch Powertube, 625 Wh, removeable, lockable



Bosch Purion



Shimano SLX M7100, 12-speed



Shimano SLX M7100, 12-speed



Shimano SLX M7100, 12-speed



FSA CK-320, aluminium



Front: 34, rear: 10-51



BBB Ascension BHB-110, aluminium, riserbar, 780 mm, rise: 20 mm, backsweep: 9degree



FOCUS Locker SL



BBB Jumper BHS-138



VP Components, ZS56 / 28,6-ZS56 / 40



FOCUS Trail SL



Kindshock E30i, 31,6 mm



Shimano BR-MT520, 4 piston



200 / 200



RaceFace AR30 Offset



Novatec D041, 15x110 mm / Novatec D162 Disc, 12x148 mm



Maxxis Rekon 2.6 Dual Exo TR



Maxxis Rekon 2.6 Dual Exo TR



Stone Blue, Magic Black



23,5 kg

GEOMETRY

THRON²
6.9 / 6.8 / 6.7 / 6.8 EQP / 6.7 EQP

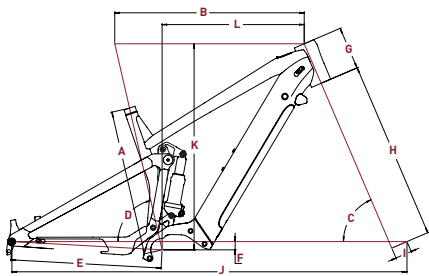

WHEEL SIZE	S	M	L	XL
WHEEL DIAMETER	27.5" + / 29"	27.5" + / 29"	27.5" + / 29"	27.5" + / 29"
A SEAT TUBE LENGTH (MM)	400	440	470	500
B TOP TUBE LENGTH (MM)	584	603	627	651
C STEERING ANGLE (°)	66,8	66,8	66,8	66,8
D SEAT TUBE ANGLE (°)	74,5	74,5	74,5	74,5
E CHAINSTAY LENGTH (MM)	455	455	455	455
F BOTTOM BRACKET DROP (MM)	25	25	25	25
G HEAD TUBE LENGTH (MM)	115	130	147	163
H FORK CONSTRUCTION HEIGHT (MM)	540	540	540	540
I PRE-RAKED FORK (MM)	51	51	51	51
J WHEELBASE LENGTH (MM)	1175	1196	1223	1249
K STACK (MM)	609	623	639	653
L REACH (MM)	415	430	450	470
STEM	60	60	60	60
CRANK	165 / 170(EQP)	165 / 170(EQP)	165 / 170(EQP)	165 / 170(EQP)

JAM²
9.9 DRIFTER / 6.9 DRIFTER

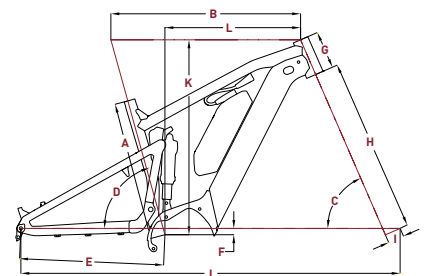

WHEEL SIZE	S	M	L	XL*
WHEEL DIAMETER	27.5" + / 29"	27.5" + / 29"	27.5" + / 29"	27.5" + / 29"
A SEAT TUBE LENGTH (MM)	410	440	470	500
B TOP TUBE LENGTH (MM)	584	604	624	649
C STEERING ANGLE (°)	65,6	65,6	65,6	65,6
D SEAT TUBE ANGLE (°)	73,6	73,6	73,6	73,6
E CHAINSTAY LENGTH (MM)	457	457	457	457
F BOTTOM BRACKET DROP (MM)	18	18	18	18
G HEAD TUBE LENGTH (MM)	120	120	140	160
H FORK CONSTRUCTION HEIGHT (MM)	557	557	557	557
I PRE-RAKED FORK (MM)	51	51	51	51
J WHEELBASE LENGTH (MM)	1188	1204	1219	1250
K STACK (MM)	624	624	634	652
L REACH (MM)	405	425	440	455
STEM	50	50	50	50
CRANK	165	165	165	165

JAM²
9.8 NINE / 6.6 NINE

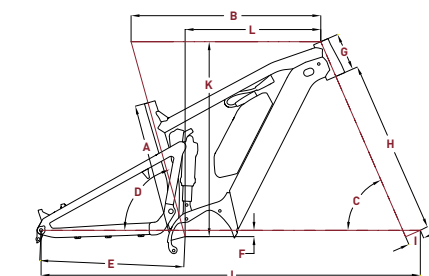

WHEEL SIZE	S	M	L	XL
WHEEL DIAMETER	29"	29"	29"	29"
A SEAT TUBE LENGTH (MM)	410	440	470	500
B TOP TUBE LENGTH (MM)	582	602	622	647
C STEERING ANGLE (°)	66,1	66,1	66,1	66,1
D SEAT TUBE ANGLE (°)	74,1	74,1	74,1	74,1
E CHAINSTAY LENGTH (MM)	470	470	470	470
F BOTTOM BRACKET DROP (MM)	16,5	16,5	16,5	16,5
G HEAD TUBE LENGTH (MM)	120	120	140	160
H FORK CONSTRUCTION HEIGHT (MM)	561	561	561	561*
I PRE-RAKED FORK (MM)	51	51	51	51
J WHEELBASE LENGTH (MM)	1198	1218	1233	1264
K STACK (MM)	620	620	638	656
L REACH (MM)	405	425	440	455
STEM	55	55	55	55
CRANK	165	165	165	165

JAM²
6.8 PLUS / 6.7 PLUS

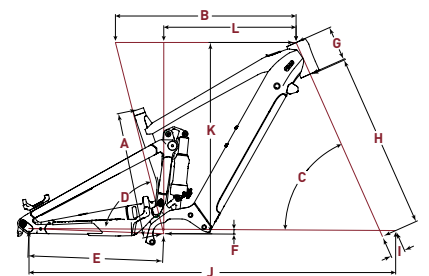

WHEEL SIZE	S	M	L	XL
WHEEL DIAMETER	27.5" +	27.5" +	27.5" +	27.5" +
A SEAT TUBE LENGTH (MM)	400	420	440	490
B TOP TUBE LENGTH (MM)	573	600	630	660
C STEERING ANGLE (°)	66	66	66	66
D SEAT TUBE ANGLE (°)	75,5	75,5	75,5	75,5
E CHAINSTAY LENGTH (MM)	427	427	427	427
F BOTTOM BRACKET DROP (MM)	10	10	10	10
G HEAD TUBE LENGTH (MM)	110	115	130	150
H FORK CONSTRUCTION HEIGHT (MM)	561	561	561	561*
I PRE-RAKED FORK (MM)	51	51	51	51
J WHEELBASE LENGTH (MM)	1163	1190	1221	1254
K STACK (MM)	607	612	625	643
L REACH (MM)	420	445	470	490
STEM	45	45	45	45
CRANK	165	165	165	165

JAM²
6.8 NINE / 6.7 NINE

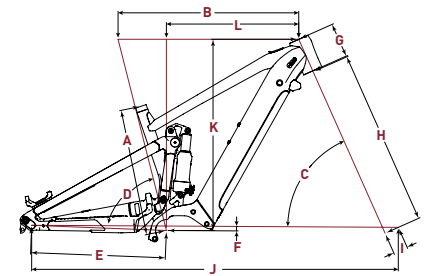

WHEEL SIZE	S	M	L	XL
WHEEL DIAMETER	29"	29"	29"	29"
A SEAT TUBE LENGTH (MM)	400	420	440	490
B TOP TUBE LENGTH (MM)	565	592	622	652
C STEERING ANGLE (°)	65,5	65,5	65,5	65,5
D SEAT TUBE ANGLE (°)	75	75	75	75
E CHAINSTAY LENGTH (MM)	447	447	447	447
F BOTTOM BRACKET DROP (MM)	19,5	19,5	19,5	19,5
G HEAD TUBE LENGTH (MM)	110	115	130	150
H FORK CONSTRUCTION HEIGHT (MM)	561	561	561	561
I PRE-RAKED FORK (MM)	51	51	51	51
J WHEELBASE LENGTH (MM)	1183	1210	1241	1274
K STACK (MM)	607	612	625	643
L REACH (MM)	412	437	462	487
STEM	45	45	45	45
CRANK	165	165	165	165

JAM²
6.6 PLUS

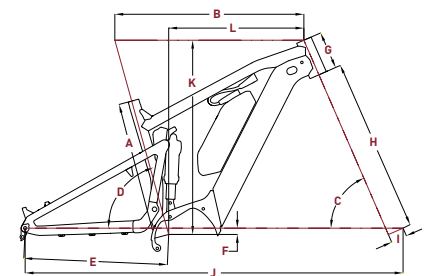

WHEEL SIZE	S	M	L	XL
WHEEL DIAMETER	27.5" +	27.5" +	27.5" +	27.5" +
A SEAT TUBE LENGTH (MM)	410	440	470	500
B TOP TUBE LENGTH (MM)	582	602	622	647
C STEERING ANGLE (°)	66,1	66,1	66,1	66,1
D SEAT TUBE ANGLE (°)	74,1	74,1	74,1	74,1
E CHAINSTAY LENGTH (MM)	457	457	457	457
F BOTTOM BRACKET DROP (MM)	16,5	16,5	16,5	16,5
G HEAD TUBE LENGTH (MM)	120	120	140	160
H FORK CONSTRUCTION HEIGHT (MM)	561	561	561	561*
I PRE-RAKED FORK (MM)	51	51	51	51
J WHEELBASE LENGTH (MM)	1185	1205	1218	1251
K STACK (MM)	620	620	638	656
L REACH (MM)	405	425	440	455
STEM	55	55	55	55
CRANK	165	165	165	165

FOCUS SAM²
6.8 / 6.7

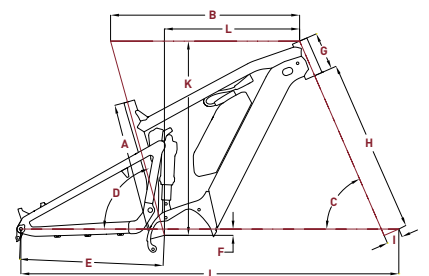

WHEEL SIZE	S	M	L
WHEEL DIAMETER	27.5"	27.5"	27.5"
A SEAT TUBE LENGTH (MM)	420	440	480
B TOP TUBE LENGTH (MM)	585	604	624
C STEERING ANGLE (°)	65	65	65
D SEAT TUBE ANGLE (°)	75	75	75
E CHAINSTAY LENGTH (MM)	455	455	455
F BOTTOM BRACKET DROP (MM)	12	12	12
G HEAD TUBE LENGTH (MM)	118	118	138
H FORK CONSTRUCTION HEIGHT (MM)	562	562	562
I PRE-RAKED FORK (MM)	42	42	42
J WHEELBASE LENGTH (MM)	1196	1217	1240
K STACK (MM)	607	607	625
L REACH (MM)	425	440	455
STEM	40	40	40
CRANK	165	165	165

RAVEN²
9.8 / 9.7

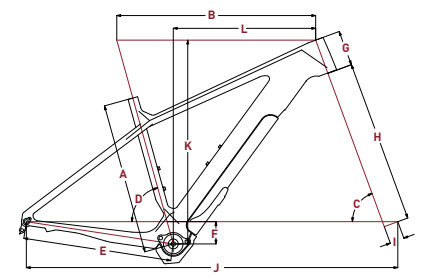

WHEEL SIZE	S	M	L
WHEEL DIAMETER	29"	29"	29"
A SEAT TUBE LENGTH (MM)	420	460	500
B TOP TUBE LENGTH (MM)	592	608	629
C STEERING ANGLE (°)	69,8	69,8	69,8
D SEAT TUBE ANGLE (°)	74,5	74,5	74,5
E CHAINSTAY LENGTH (MM)	454	454	454
F BOTTOM BRACKET DROP (MM)	68	68	68
G HEAD TUBE LENGTH (MM)	104	107	130
H FORK CONSTRUCTION HEIGHT (MM)	501	501	501
I PRE-RAKED FORK (MM)	44	44	44
J WHEELBASE LENGTH (MM)	1100	1116	1139
K STACK (MM)	620	623	644
L REACH (MM)	420	435	450
STEM	90	90	90
CRANK	175	175	175

STANDOVER MEASURED 150MM IN FRONT OF THE BB
*ONLY ALUMINUM

POS	PART #	PART NAME	QTY
01	K020420010	REAR TRIANGLE	1
02	K025929998	LINKAGE SET	1
03	K025920004	HANGER	1
04	K025920005	HANGER NUT	1
05	K0160218036	THRU AXLE 12X148MM	1
06	K025920047	AXLE WASHER RIGHT 16X8MM	1
07	K025920048	AXLE WASHER LEFT 12X9.5MM	1
08	K025920049	POST MOUNT ADAPTER "200MM LOW"	1
09	K025920050	POST MOUNT ADAPTER "200MM HIGH"	1
10	K025920006	L-BRACKET (LOCK SIDE) FOR BATTERY MOUNT	1
11	K025920007	TWIN WASHER (LOWER) 27X20 FOR BATTERY MOUNT	1
12	K0199318004	TWIN WASHER (UPPER) 26X12 FOR FORK BUMPER	1
13	K025920021	FORK BUMPER	1
14	NORM PART	SCREW DIN 7991 M6X 20	4
15	K025920024	BATTERY COVER PT 600	1
16	NORM PART	SCREW DIN 7991 M3X 10	8
17	NORM PART	HEXAGON THIN NUT DIN 439-1 M3	2
18	K025920025	CHARGER PLUG BRACKET	1
19	K025920026	CHARGER PLUG COVER	1
20	K025920027	LOCK COVER	1
21	K025920028	CABLE CHANNEL DT	1

22	K0325918147	CABLE EXIT PLUG BB	1
23	K0325929997	BEARING SET	2
24	K0325929996	PIVOT SET	1
25	K0199119008	FOCUS BOTTLE CAGE SCREW M5X 12	2
26	K0325920051	CHAINSTAY PROTECTOR	1
27	K0325920052	SEATSTAY PROTECTOR	1
28	K0325920023	MOTOR COVER SET	1
29	K0325920053	CHAINGUIDE	1
30	NORM PART	SCREW ISO14583 M6X 20	3
31	NORM PART	WASHER M6 DIN125	3
32	K0325917027	CABLE GUIDE	1
33	NORM PART	SCREW DIN 7991 M5X 8	1
34	K0325920029	CABLE PLUG DT (3 CABLES)	2
35	K0325919267	DCW DIZ CABLE PLUG V-1 (ONLY FOR D12)	1
36	K0325916095	BRAKE CABLE PROTECTION TUBE PVC 6X 7 X 150	2
37	K0170520003	SPEEDMAGNET ADP-SHEB-2	1
38	K0199120009	THREAD-FORMING TAP SCREW M4X 8	3
39	NORM PART	SCREW DIN 7380 M6X 8	1
40	K0170620099	BATTERY EXTENSION (ONLY FOR PT 500 WH)	1
41	NORM PART	SCREW DIN 7984 M4 X 14 (ONLY FOR PT 500 WH)	4
42	NORM PART	SCREW DIN 7984 M4 X 10	1

MATERIAL	ALUMINUM
WHEELSIZE	27+" MAX 2.8" / 70MM, 29" MAX 2.6" / 66MM
TRAVEL	FRONT 150MM / REAR 150MM
FORK	27+" / 29" LENGTH 561MM / RAKE 42MM
SHOCK	LENGTH 210MM / STROKE 55MM, HARDWARE 25X 8MM
HEADSET	UPPER 25 56, LOWER 25 56
BOTTOM BRACKET	-
SEATPOS / SEATCLAMP	Ø 31,6MM / Ø 34,9MM, MINIMUM INSERT: 100MM
BRAKEMOUNT	POSTMOUNT 200MM, MAX ROTOR: 203MM
REAR AXLE	WIDTH 148MM / Ø 12MM
ENGINE	BOSCH CX GENERATION 4
BATTERY	BOSCH POWER TUBE 625WH
MAX SYSTEM WEIGHT	120KG

